

DESCRIPTION

Cooling devices for using with solid relay and in order to extend service life and durable in solid relay. There are several sizes in both of 1 phase and 3 phase systems.

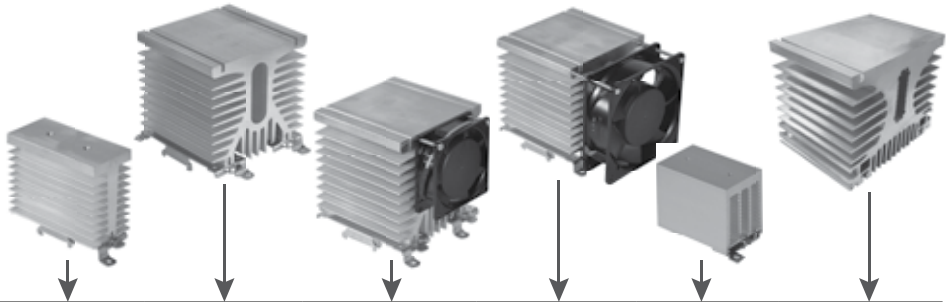

Model	HP-01	HP-02	HP-02-F	HP-02-FB	HP-03	HP-04
Thermal Characteristics	1.95 kW	0.9 kW	0.3 kW	0.2 kW	1.95 kW	0.75 kW
Type	1Ø SSR	3Ø SSR	3Ø SSR	3Ø SSR	1Ø SSR	3Ø SSR
Specifications	for DIN RAIL	for DIN RAIL	Ventiled for DIN RAIL With Fan Supply 220/240 VAC	Ventiled for DIN RAIL With Fan Supply 220/240 VAC	for DIN RAIL	for DIN RAIL
Fans	None	None	SF23080AT (HBL.GN)	FP-108-1(S-1)	None	None
Air Volume	None	None	18 CFM 0.5 M ³ /Min	80 CFM 2.3 M ³ /Min	None	None
Weight	0.68 Kg.	2.02 Kg.	2.28 Kg.	2.54 Kg.	0.32 Kg.	1.25 Kg.

DIMENSION

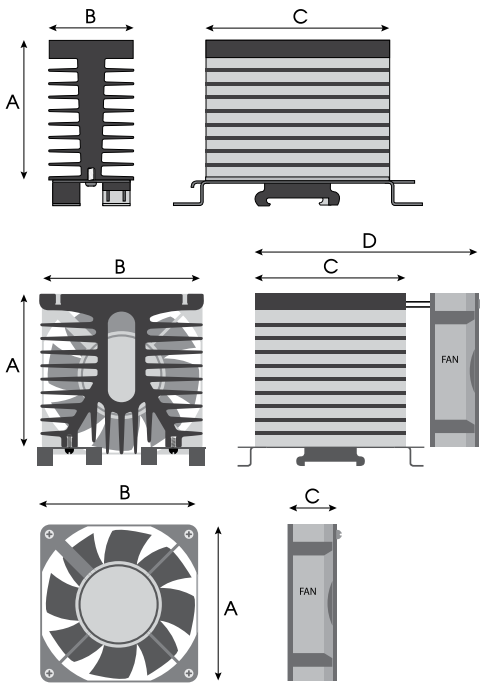

Dimensions (mm.)	A	B	C
HP-01	95 mm.	51 mm.	111 mm.
HP-02	123 mm.	119 mm.	110 mm.
HP-03	60 mm.	48 mm.	78 mm.
HP-04	100 mm.	80 mm.	110 mm.

Dimensions (mm.)	A	B	C	D
HP-02-F	123 mm.	120 mm.	110 mm.	137 mm.
HP-02-FB	123 mm.	120 mm.	110 mm.	168 mm.

Dimensions (mm.)	A	B	C
F (Fan for HP-02-F)	80 mm.	80 mm.	25 mm.
FB (Fan for HP-02-FB)	119 mm.	119 mm.	38 mm.

INSTALLATION

OPERATION

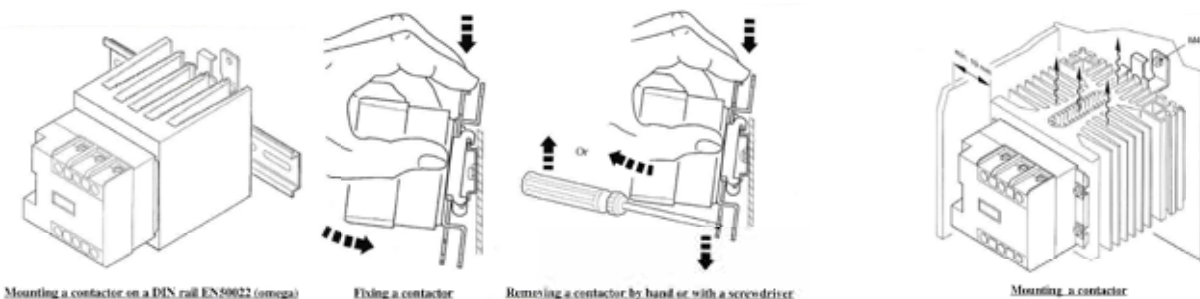

Mounting a contactor on a DIN rail ES50022 (omega)

Fixing a contactor

Removing a contactor by hand or with a screwdriver

Mounting a contactor